

REV.	ECN NO.	DESCRIPTION	DATE	DRAWN
A		NEW RELEASE	2008.12.18	ROSE

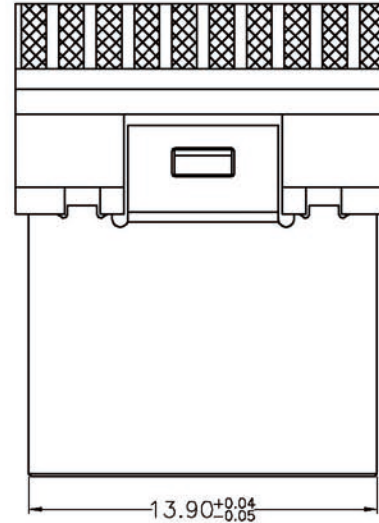
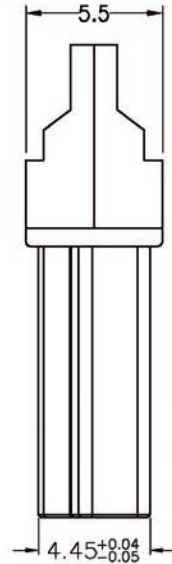
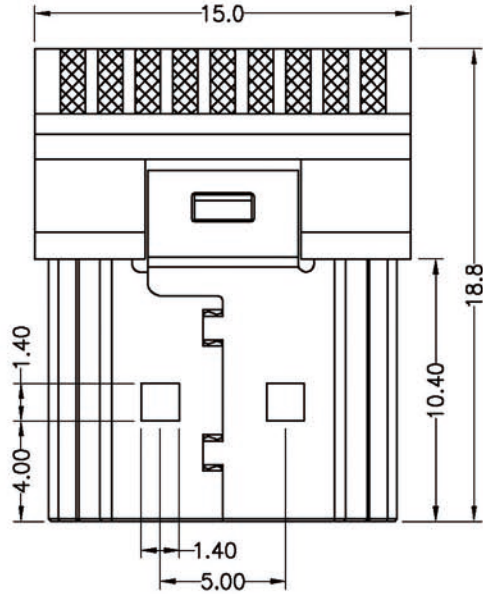

1.MECHANICAL:

- 1.1 INSERTION FORCE: 44.1N MAX.
- 1.2 WITHDRAWAL FORCE: 9.8N MIN.
- 1.3 DURABILITY: 10,000 CYCLES MIN.

2.ELECTRICAL:

- 2.1 CONTACT RESISTANCE: 30mΩ MAX.
- 2.2 INSULATION RESISTANCE: 100MΩ MIN.
- 2.3 DIELECTRIC WITHSTANDING VOLTAGE: 500V AC

3.ENVIRONMENTAL:

- 3.1 TEMPERATURE RANGE: -20°C TO +85°C

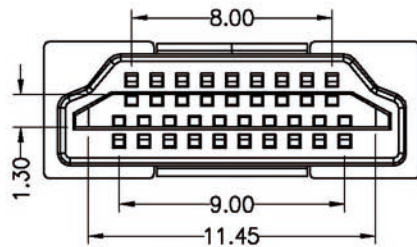

ORDER INFORMATION:
HM19-BS**-MA03

- SHELL PLATING
- G:GOLD PLATED
- N:NICKEL PLATED
- CONTACT PLATING
- 1:GOLD FLASH
- 2:GOLD 3μ"
- 3:GOLD 5μ"
- 4:GOLD 10μ"
- 5:GOLD 15μ"
- 6:GOLD 30μ"

ITEM	NAME	Q'TY	MATERIAL	FINISH
3	HOUSING	3	HIGH TEMPERATURE THERMOPLASTICS,UL94V-0(LCP)	
2	CONTACTS	19	COPPER ALLOY	GOLD/TIN OVER NICKEL
1	SHELL	1	COPPER ALLOY & SPCC	NICKEL OR GOLD PLATED

GENERAL TOLERANCE	APPROVED	LYNDAHL by Traderia GmbH					
X.X ±0.30	CHECKED	Item # LKHMICON19-1					
X.XX ±0.15	DESIGN	TITLE					
X.XXX ±0.05	DRAWN	HDMI A TYPE					
		ROSE 2008.12.18	PART NO. LKHMICON19-1				
			UNIT	SIZE	SCALE	SHEET	REV. A
			mm	A4	1 : 1	1 / 1	

